



How to Install an XCX D-type guide (high direct mount)

Written By: Dozuki System





TOOLS:

- [5mm hex wrench](#) (1)
 - [4mm hex wrench](#) (1)
-

Step 1 — How to Install an XCX D-type guide (high direct mount)



- XCX D-type guides will accommodate chainlines from 49- 53.5mm
- For more information on determining your chainline, please see [Chainline explained](#)
- For this retention device we adjust chainline using spacers between the chainguide backplate and the frame

Step 2



- Start by loosening the upper slider bolt and opening the upper slider

Step 3



- Install the guide on the frame with the thinner of the two black T spacers and the shorter of the two gold bolts
- This will put the chainguide at a 49mm chainline

Step 4

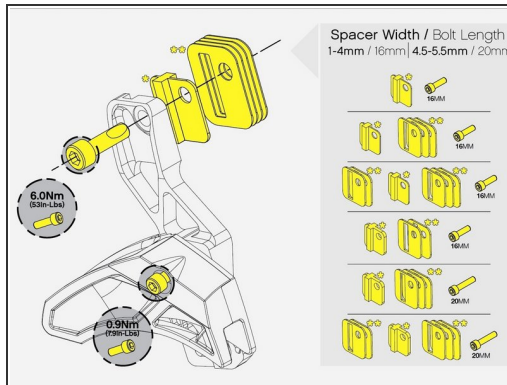
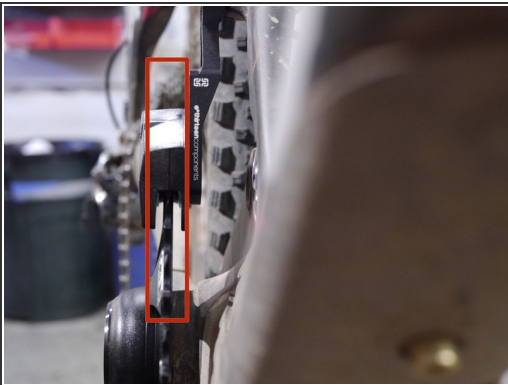

- Close the upper slider and sight down the front of the guide and chainring
- Add the silver spacers under the guide until the split in the chainguide is centered over the chainring
- Use the chart to determine the correct spacer, T spacer and bolt length for your application
 - Most bikes will use the thin black T spacer and one or two of the silver spacers

This document was generated on 2021-12-29 05:04:15 PM (MST).

Step 5

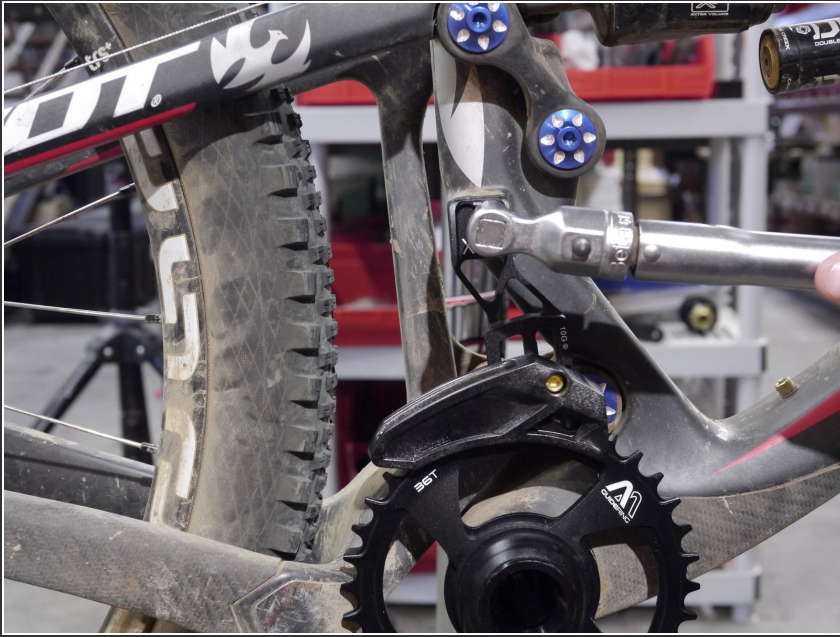

- Torque the fixing bolt to 6nm

Step 6

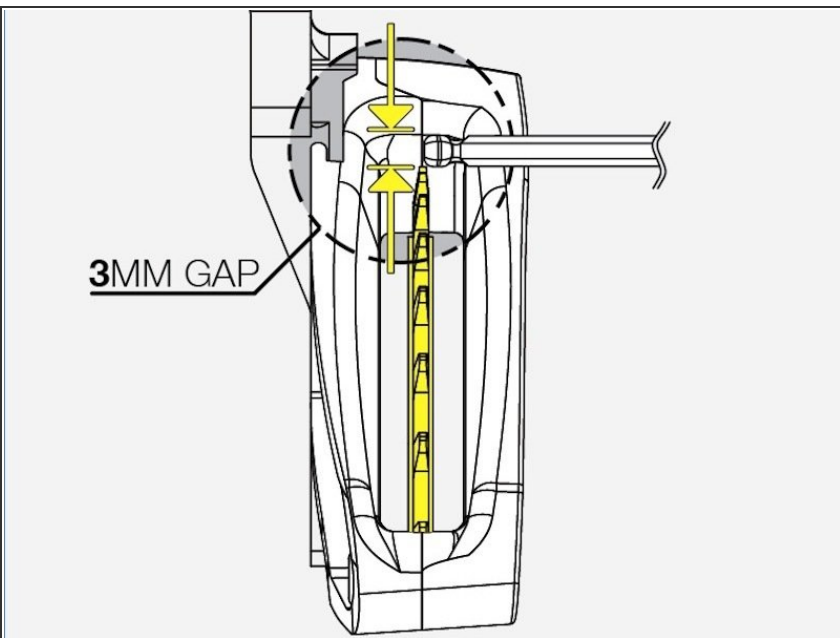

- Adjust the upper slider for your chainring size by sliding on the back plate
 - There should be ~3mm between the top of the chainring teeth and the slider
- Torque the upper slider bolt to 0.5nm or just a bit past snug
 - Do not over-tighten the slider bolt

Thanks for reading, now get out there and ride!