



How to install the EX cog on a Shimano 10sp drivetrain

Installing your Extended Range cog on Shimano 10sp drivetrains.

Written By: The Hive - Jeremy





TOOLS:

- [Cassette lockring tool](#) (1)
- [Chain whip](#) (1)
- [#2 Phillips screwdriver](#) (1)
- [3mm hex wrench](#) (1)

Step 1 — How to install the EX cog on a Shimano 10sp drivetrain

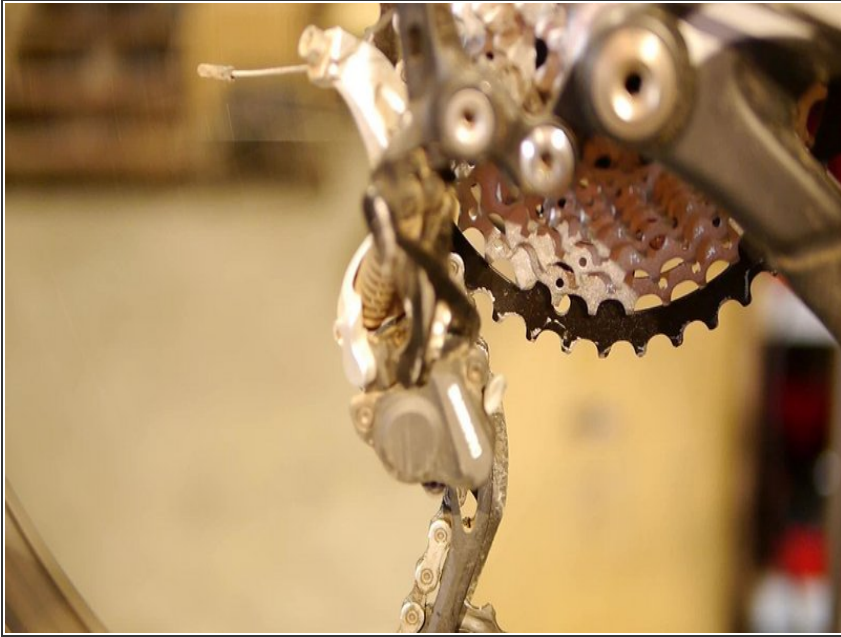

- The EX cog should only be used with a new, or nearly new drivetrain. Your chain and cassette should show no wear prior to install. Worn components will affect shifting performance.
- For Shimano 10sp drivetrains it is vital that your chain is installed correctly for good shifting performance. Refer to your Shimano chain users manual for more information.
- For 1x use, a mid cage or longer derailleur must be used
- For 2x use a long cage derailleur must be used
- Do not use with a 3x system
- Always refer to your drivetrain manufacturer's recommendations on chain wrap

Step 2

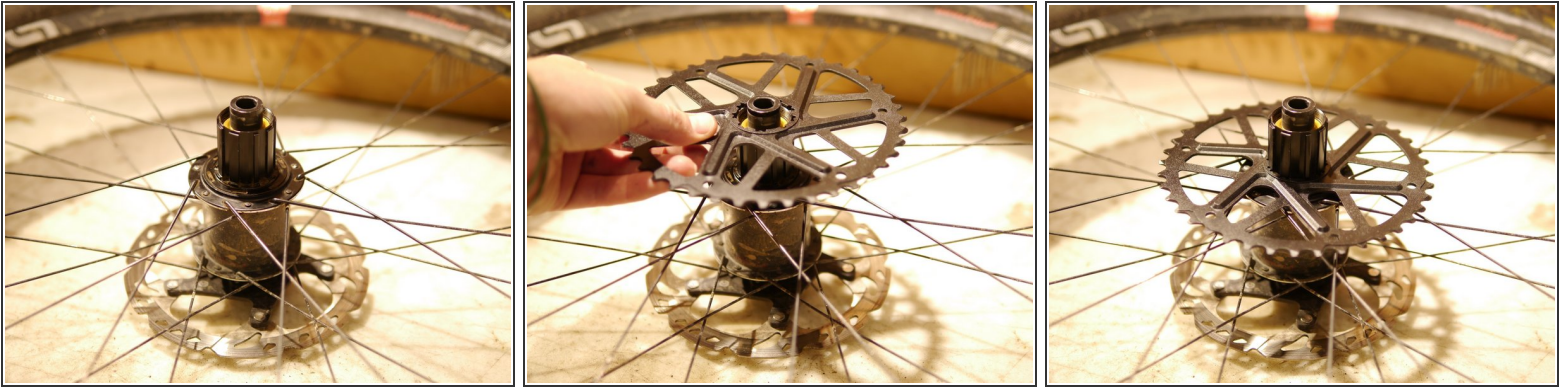

- Start by installing the EX cog onto your freehub body
- The side with the logos should be down towards the hub

Step 3



- Install your cassette
- To fit the EX cog, one of the cassette cogs will need to be left out
 - If using the 40t EX cog, leave out the 15t cog and spacer
 - If using the 42t EX cog, leave out the 17t cog and spacer
- Continue installing the cassette cogs, be sure each cog is facing the correct direction, refer to your cassette owners manual for more information

Step 4



- Lightly grease and install the cassette lockring and torque to spec.

Step 5

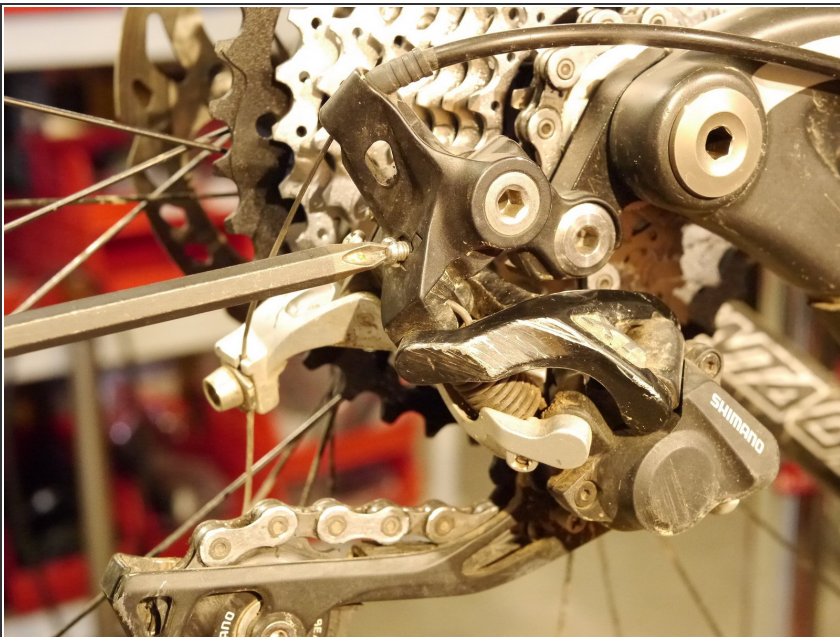

- Install the wheel back on the bike
- Check shifting quality by shifting through the higher gears (smaller cogs)
- If your cassette is not shifting properly, adjust the derailleur using only the smaller cogs.
- If you are unsure how to adjust your rear derailleur, consult your derailleur owners manual or visit your local bike shop
- You should have perfect shifting in these smaller cogs before adjusting shifting into the EX cog.

Step 6

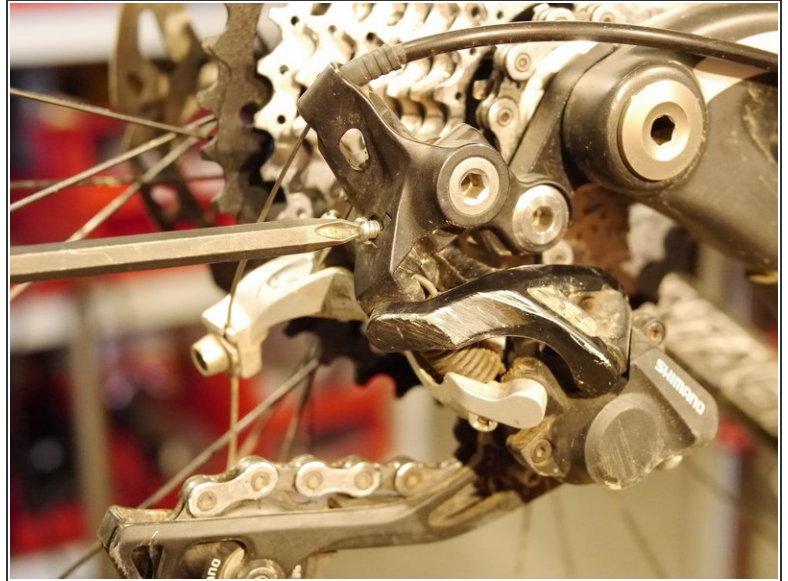

- Shift into the EX cog
- Adjust the B-limit screw so that there is a 5-6mm gap between the upper derailleur pulley teeth and the teeth on the EX cog
- If you are unsure how to adjust your B-limit screw, consult your derailleur owners manual or visit your local bike shop
- You can also hear when the B-limit is not adjusted correctly as the teeth will grind together. Adjust the B-limit screw in until quiet
- For the 42t cog, you will likely need to install the provided longer B-limit screw

Step 7

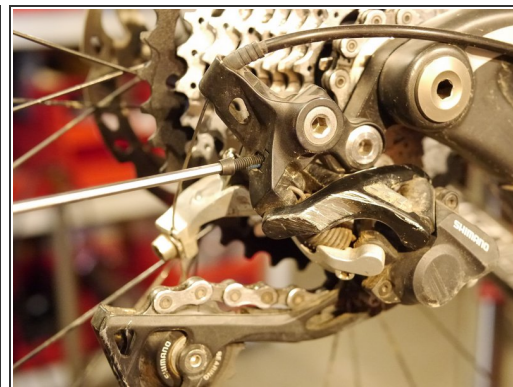
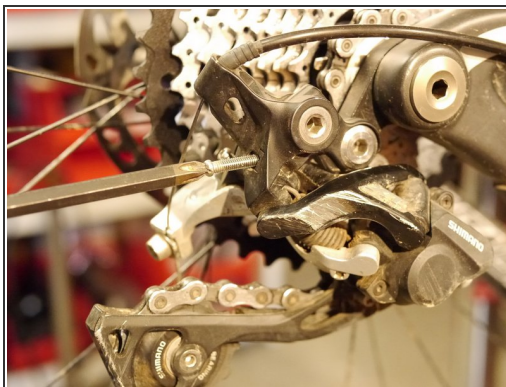

- Simply remove the stock B-limit screw and install the new one

Step 8

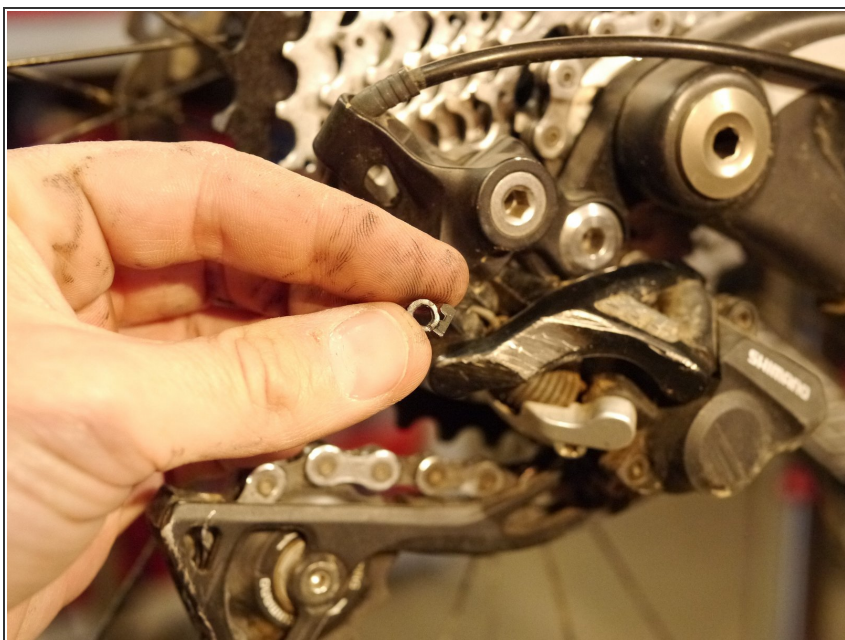

- Be careful not to lose the small plastic washer
- If it comes out be sure to re-install it

Step 9



- Check your shifting and go ride!

Thanks for reading, now get out there and ride!